

NO	DESCRIPTION OF REVISIONS	MADE BY	DATE	NO
1	RE-ISSUE	L. LOPEZ	2/02	3
2	REVISED DRAWING, CHANGE TEXT CASE, UPDATED BORDER INCREASED LINE WEIGHTS.	L. LOPEZ	6/14	4
	DESCRIPTION OF REVISIONS	MADE BY	DATE	

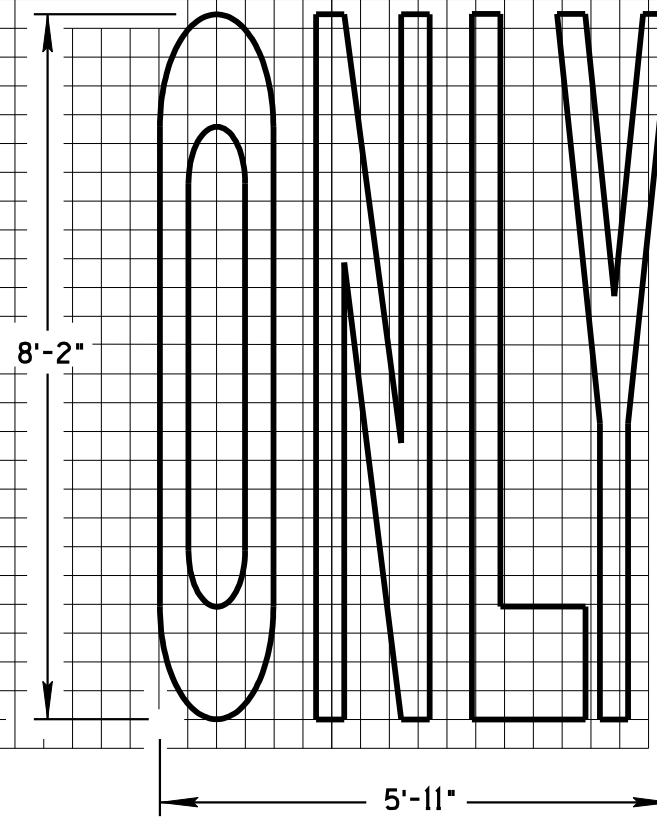
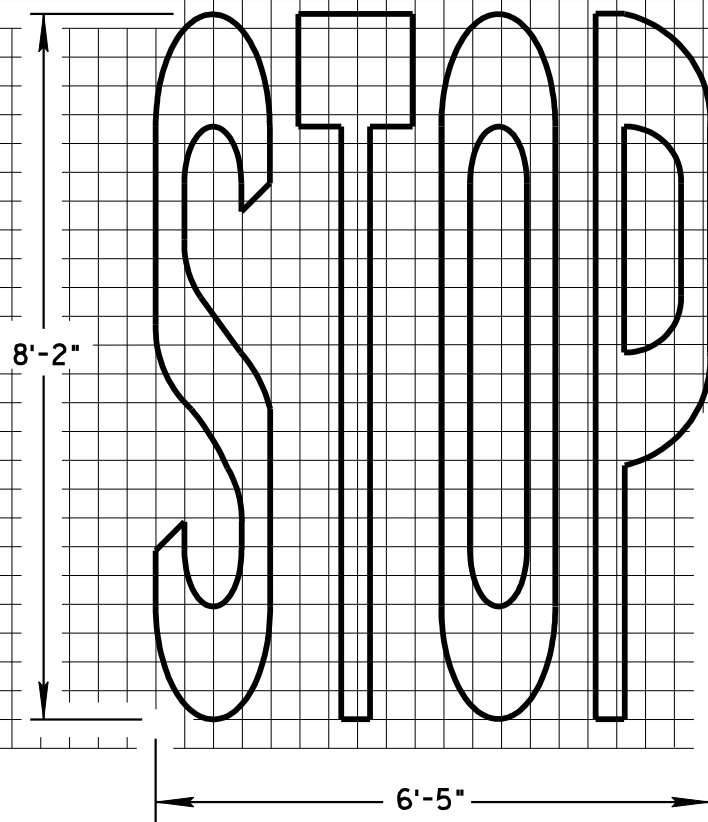
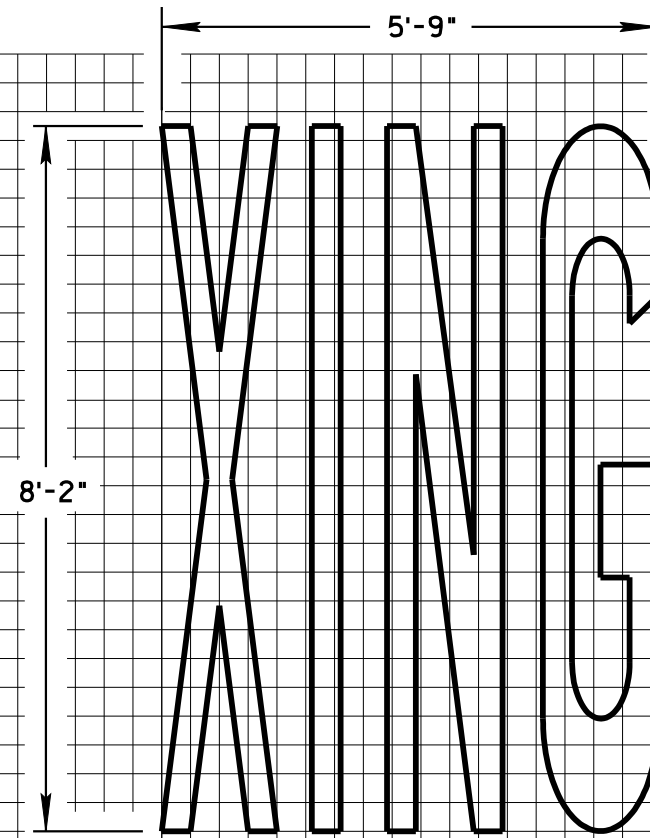
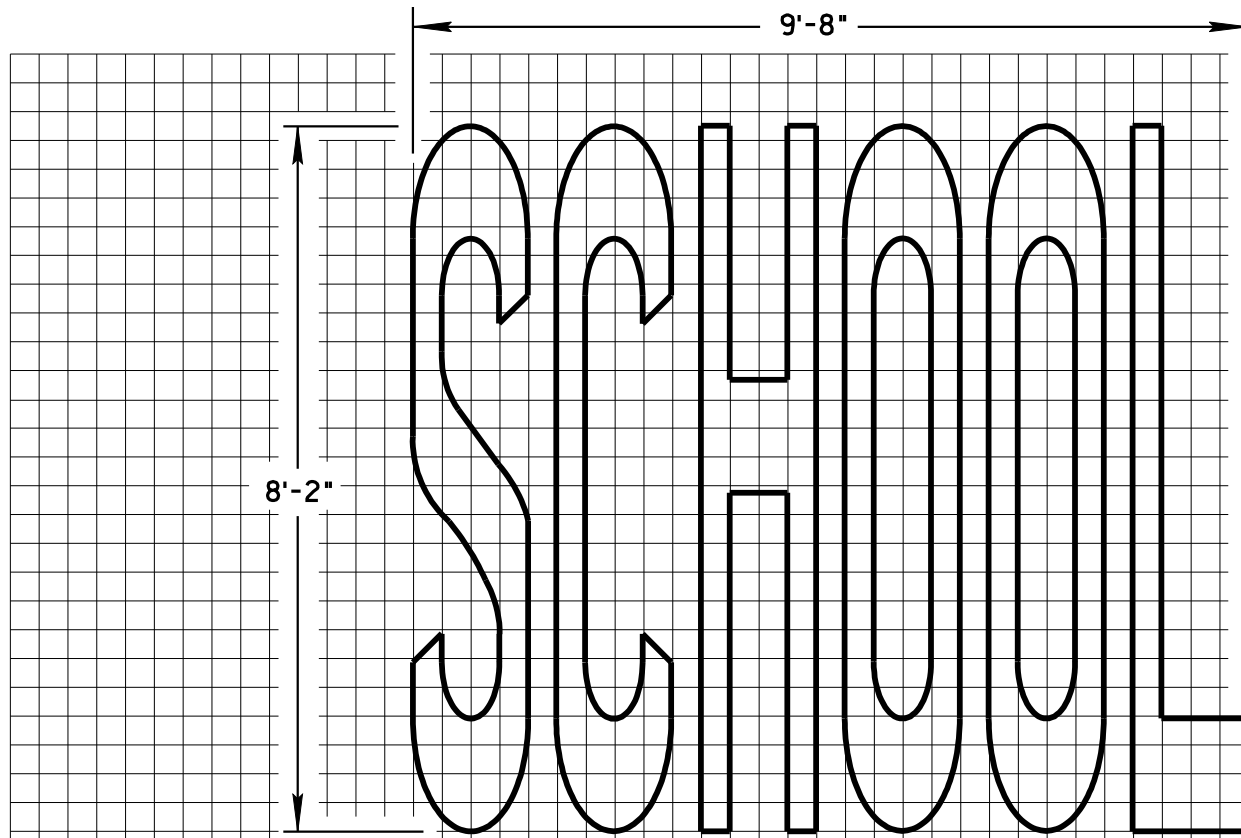

1 Unit = 4"

NOT TO SCALE

DESIGN APPROVED
SIGNATURES
APPROVED FOR DISTRIBUTION
ON FILE

ARIZONA DEPARTMENT OF TRANSPORTATION
INTERMODAL TRANSPORTATION DIVISION
TRAFFIC SIGNING & MARKING
STANDARD DRAWINGS
WORD MARKINGS

REVISION 6/14
DRAWING NO. M-6
SHEET NO. 1 of 1

NO	DESCRIPTION OF REVISIONS	MADE BY	DATE	NO
1	RE-ISSUE	L. LOPEZ	2/02	3
2	REVISED DRAWING, CHANGE TEXT CASE, UPDATED BORDER INCREASED LINE WEIGHTS.	L. LOPEZ	6/14	4

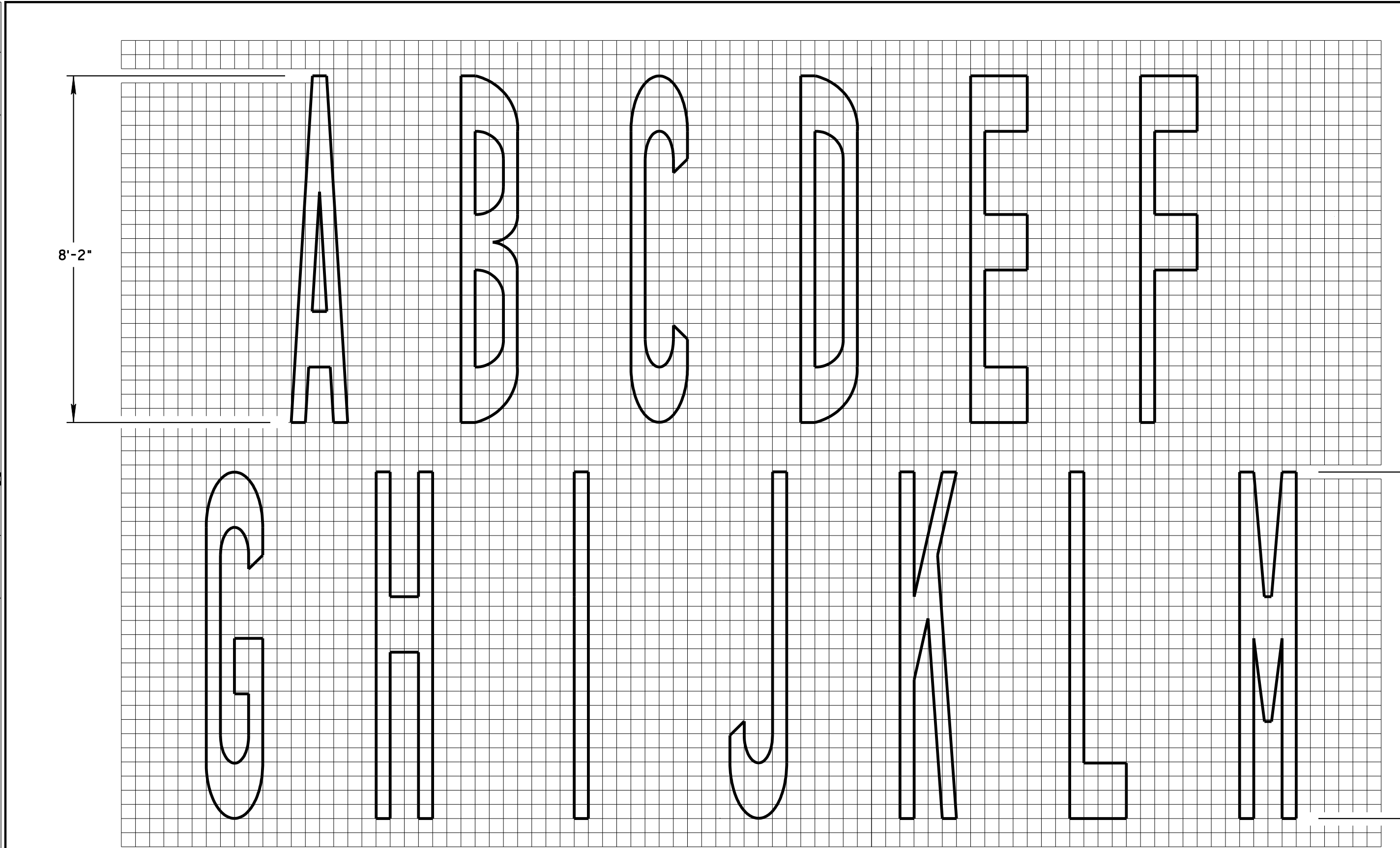

1 Unit = 4"

NOT TO SCALE

DESIGN APPROVED	ARIZONA DEPARTMENT OF TRANSPORTATION INTERMODAL TRANSPORTATION DIVISION TRAFFIC SIGNING & MARKING STANDARD DRAWINGS	REVISION
SIGNATURES		6/14
APPROVED FOR DISTRIBUTION	PAVEMENT LETTERS	DRAWING NO.
ON FILE		M-7
		SHEET NO.
		1 of 1

NO	DESCRIPTION OF REVISIONS	MADE BY	DATE	NO
1	RE-ISSUE	L. LOPEZ	2/02	3
2	REVISED DRAWING, CHANGE TEXT CASE, UPDATED BORDER INCREASED LINE WEIGHTS.	L. LOPEZ	6/14	4
	DESCRIPTION OF REVISIONS	MADE BY	DATE	

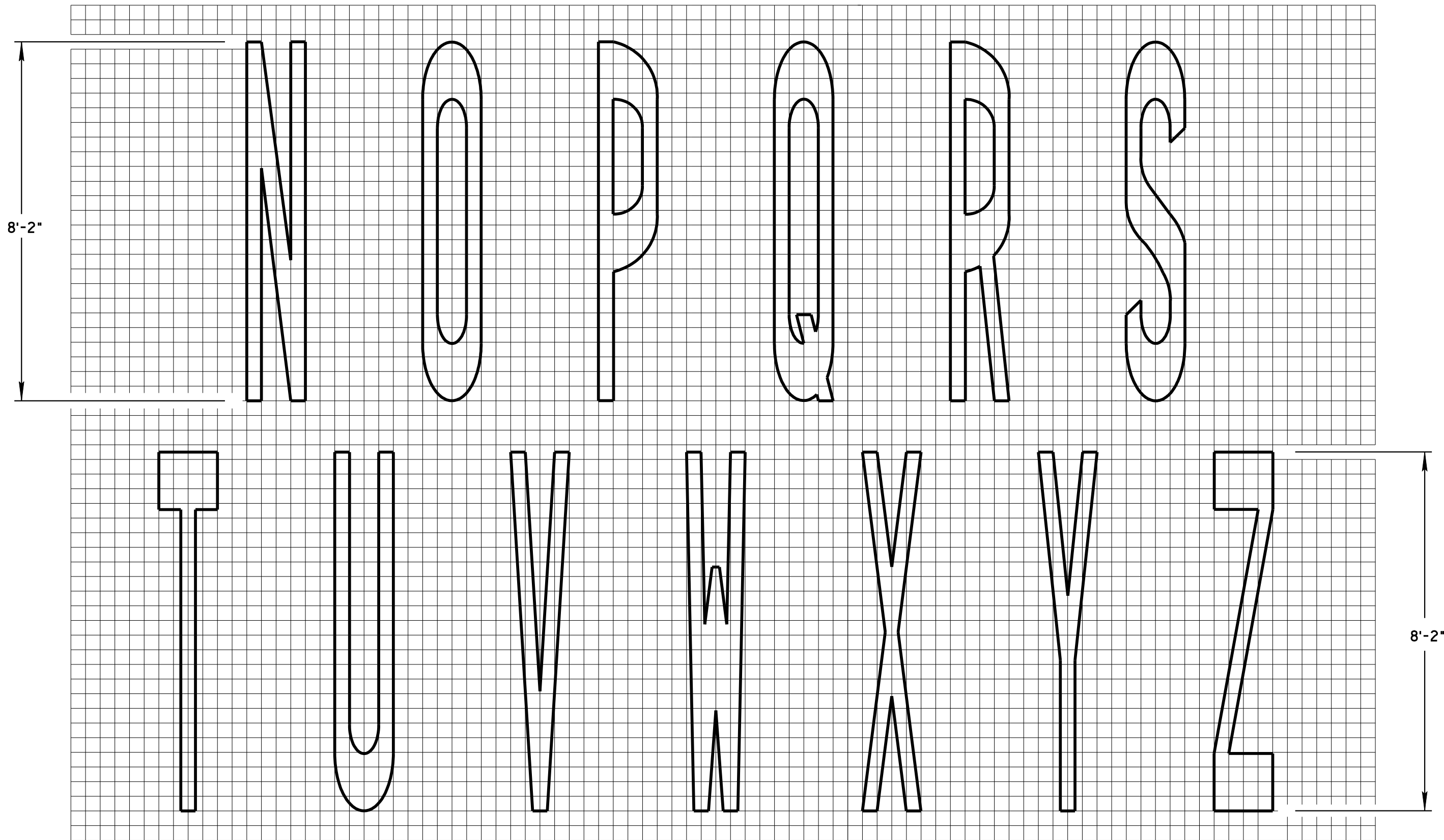

1 Unit = 4"

NOT TO SCALE

DESIGN APPROVED	ARIZONA DEPARTMENT OF TRANSPORTATION INTERMODAL TRANSPORTATION DIVISION TRAFFIC SIGNING & MARKING STANDARD DRAWINGS	REVISION
SIGNATURES		6/14
APPROVED FOR DISTRIBUTION	PAVEMENT LETTERS	DRAWING NO.
ON FILE		M-8
		SHEET NO.
		1 of 1

NO	DESCRIPTION OF REVISIONS	MADE BY	DATE	NO
1	RE-ISSUE	L. LOPEZ	2/02	3
2	REVISED DRAWING, CHANGE TEXT CASE, UPDATED BORDER INCREASED LINE WEIGHTS.	L. LOPEZ	6/14	4
	DESCRIPTION OF REVISIONS	MADE BY	DATE	

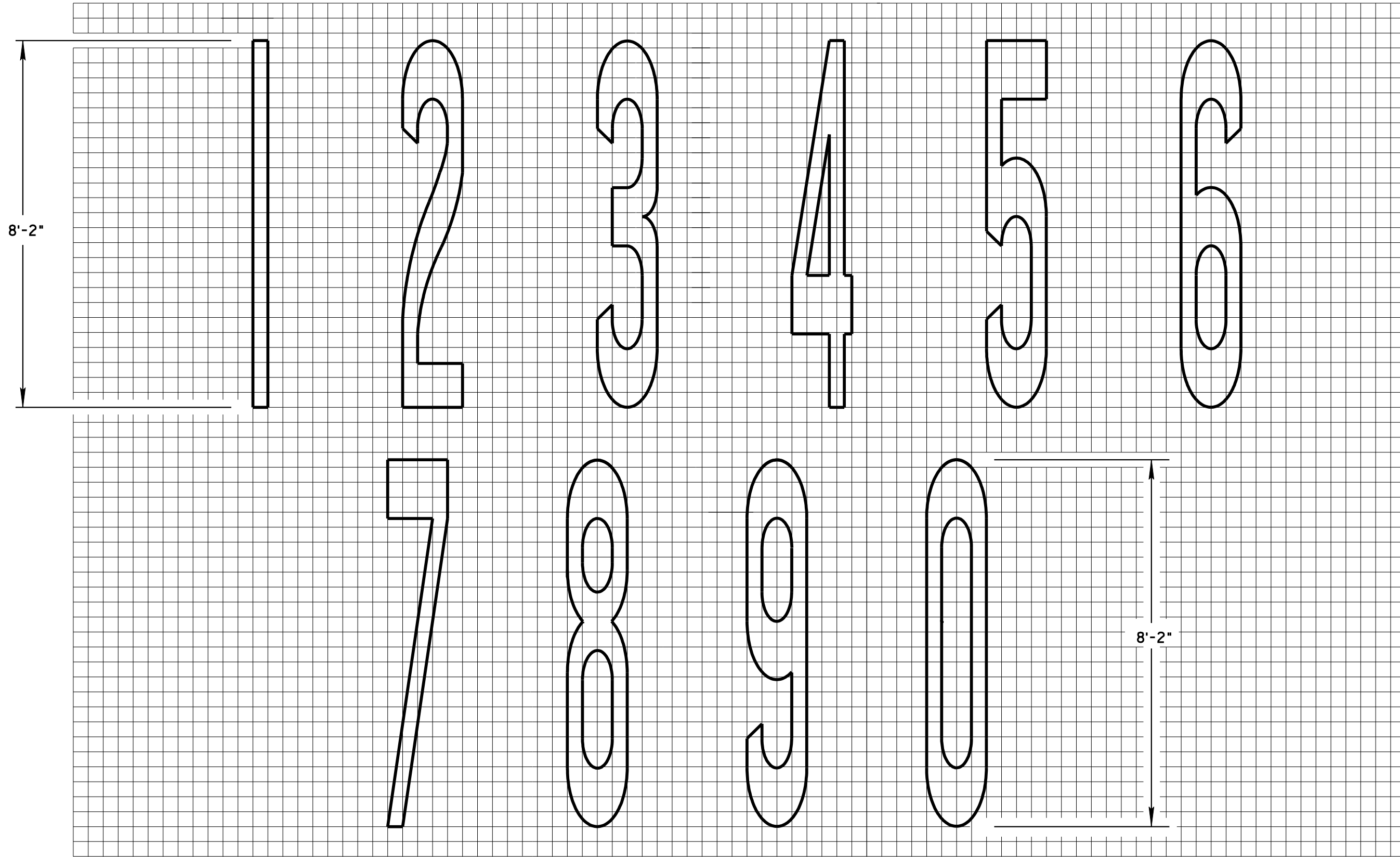

1 Unit = 4"

NOT TO SCALE

DESIGN APPROVED	ARIZONA DEPARTMENT OF TRANSPORTATION INTERMODAL TRANSPORTATION DIVISION TRAFFIC SIGNING & MARKING STANDARD DRAWINGS	REVISION
SIGNATURES		6/14
APPROVED FOR DISTRIBUTION	PAVEMENT NUMBERS	DRAWING NO.
ON FILE		M-9
		SHEET NO.
		1 of 1

NO	DESCRIPTION OF REVISIONS	MADE BY	DATE
5	ADDED 18 IN. LANE DROP ARROW & CREATED SHT. 2 OF 2.	L. LOPEZ	5/03
2	RE-DESIGNED ARROWS, ADDED TRIPLE ARROW.	L. LOPEZ	1/05

NO	DESCRIPTION OF REVISIONS	MADE BY	DATE
3	REVISED LANE DROP ARROW DETAIL & MOVED IT TO SHEET 2 OF 3.	L. LOPEZ	9/08
4	CHANGE TEXT CASE, UPDATE BORDER.	L. LOPEZ	6/14

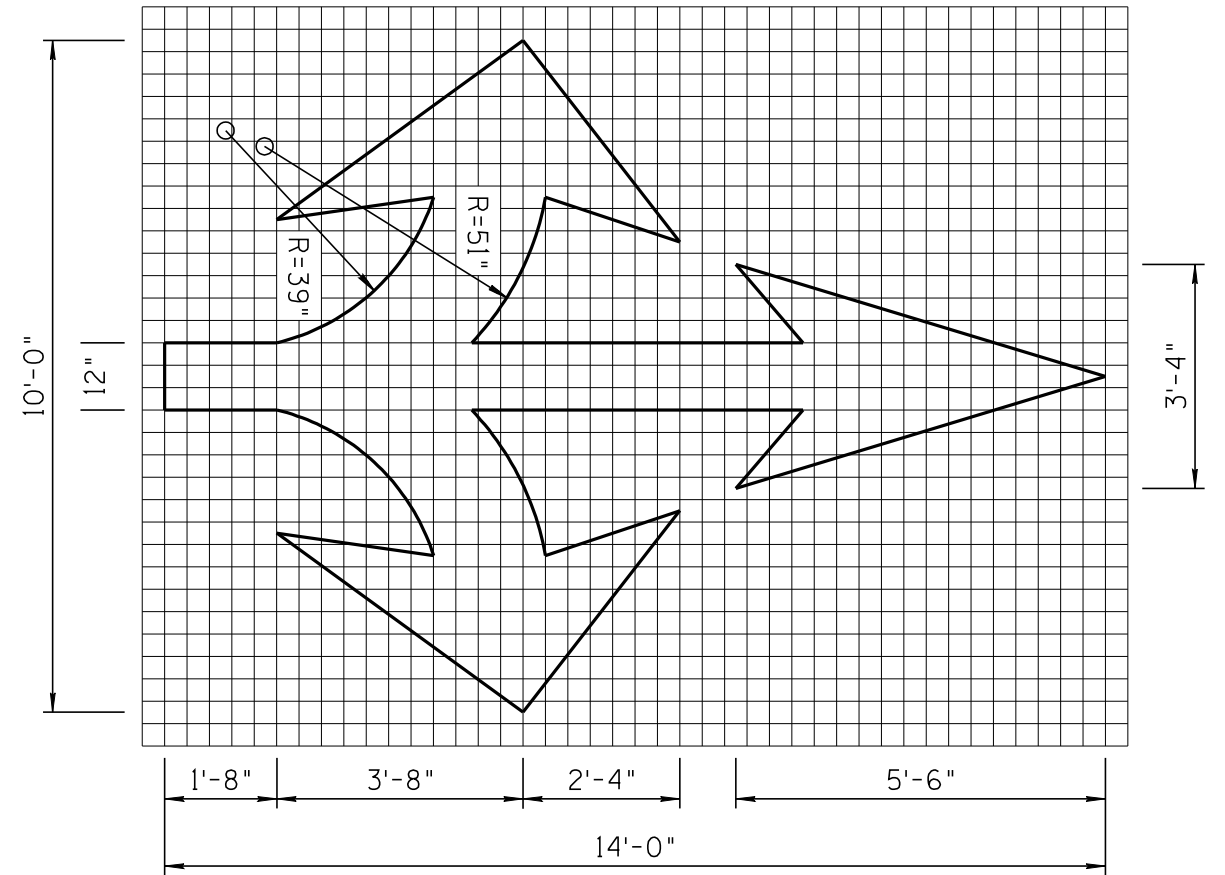
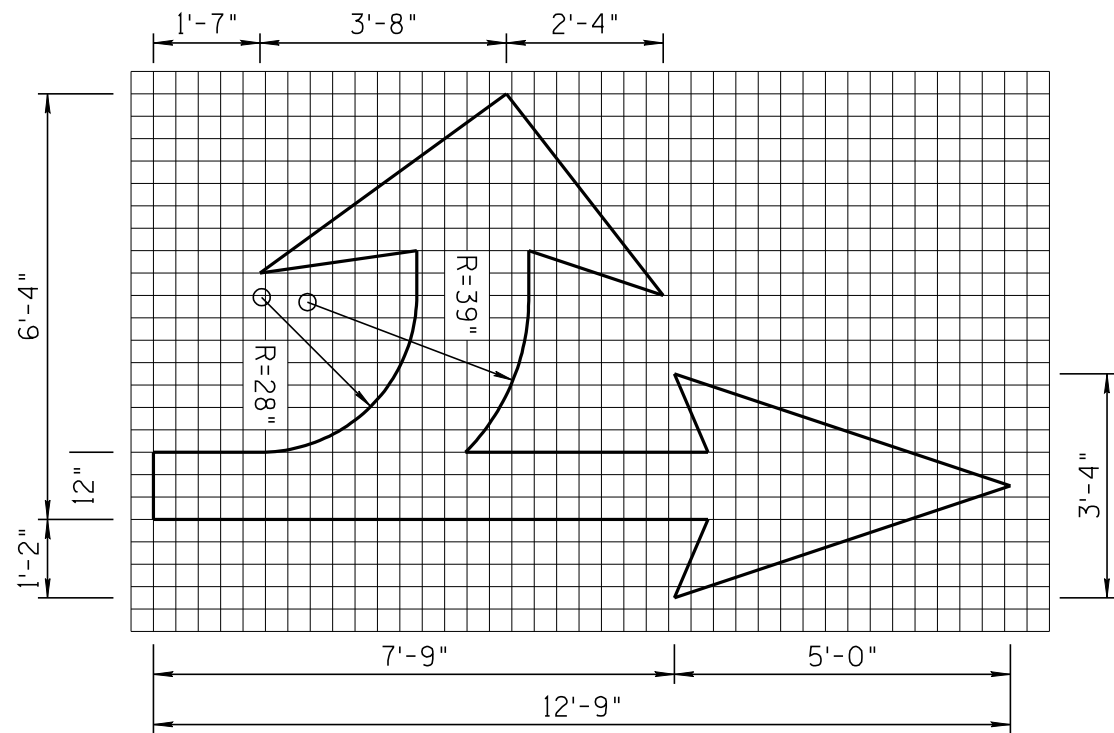

ARROW DETAILS
 1 Unit = 4"
 All Symbols/Legend
 Shall Be White

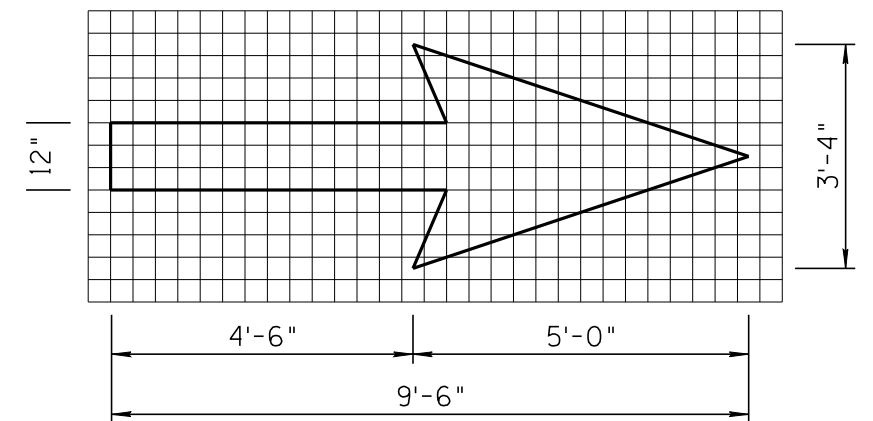
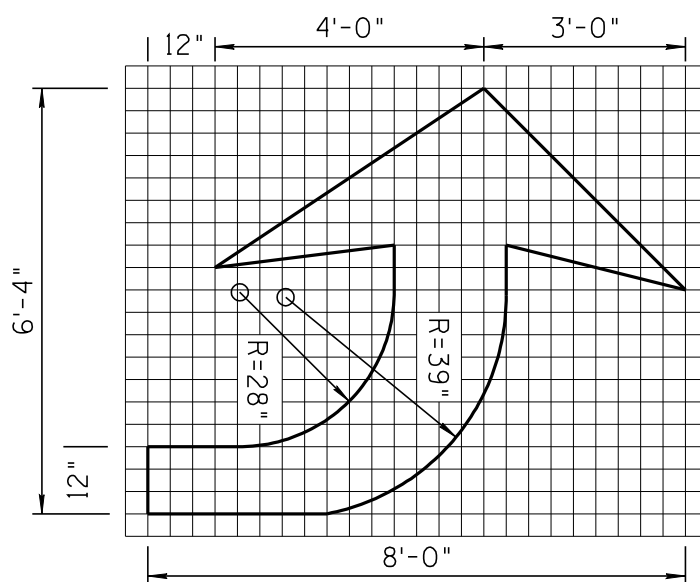
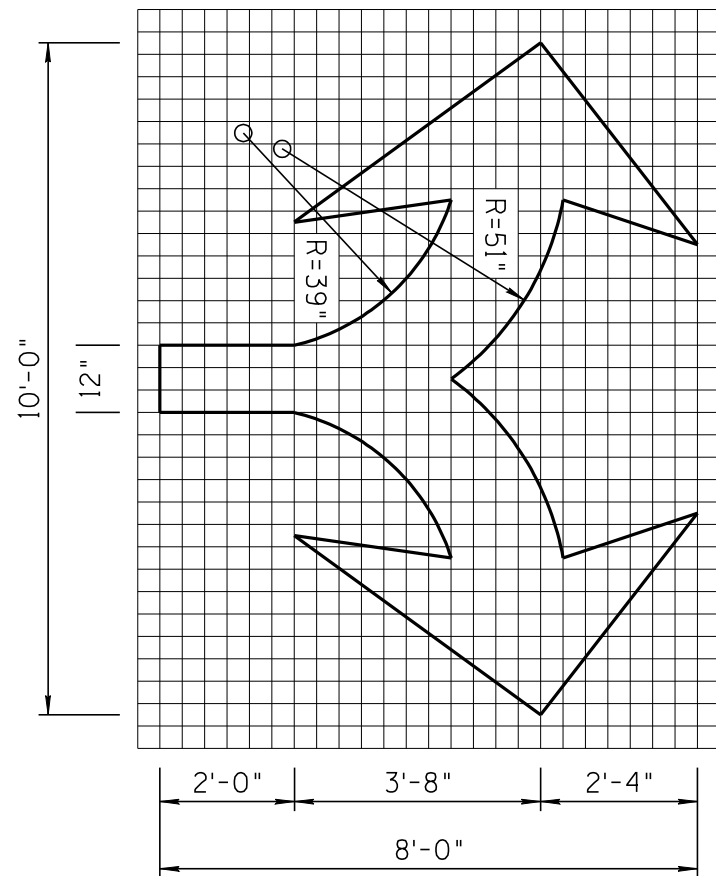

NOT TO SCALE

DESIGN APPROVED	ARIZONA DEPARTMENT OF TRANSPORTATION INTERMODAL TRANSPORTATION DIVISION TRAFFIC SIGNING & MARKING STANDARD DRAWINGS	REVISION	6/14
SIGNATURES		DRAWING NO.	M-10
APPROVED FOR DISTRIBUTION	PAVEMENT MARKING SYMBOLS	SHEET NO.	1 of 2
ON FILE			

NO	DESCRIPTION OF REVISIONS	MADE BY	DATE
5	ADDED 18 IN. LANE DROP ARROW & CREATED SHT. 2 OF 2.	L. LOPEZ	5/03
2	RE-DESIGNED ARROWS, ADDED TRIPLE ARROW.	L. LOPEZ	1/05
3	REVISED LANE DROP ARROW DETAIL & MOVED IT TO SHEET 2 OF 3.	L. LOPEZ	9/08
4	CHANGE TEXT CASE, UPDATE BORDER.	L. LOPEZ	6/14

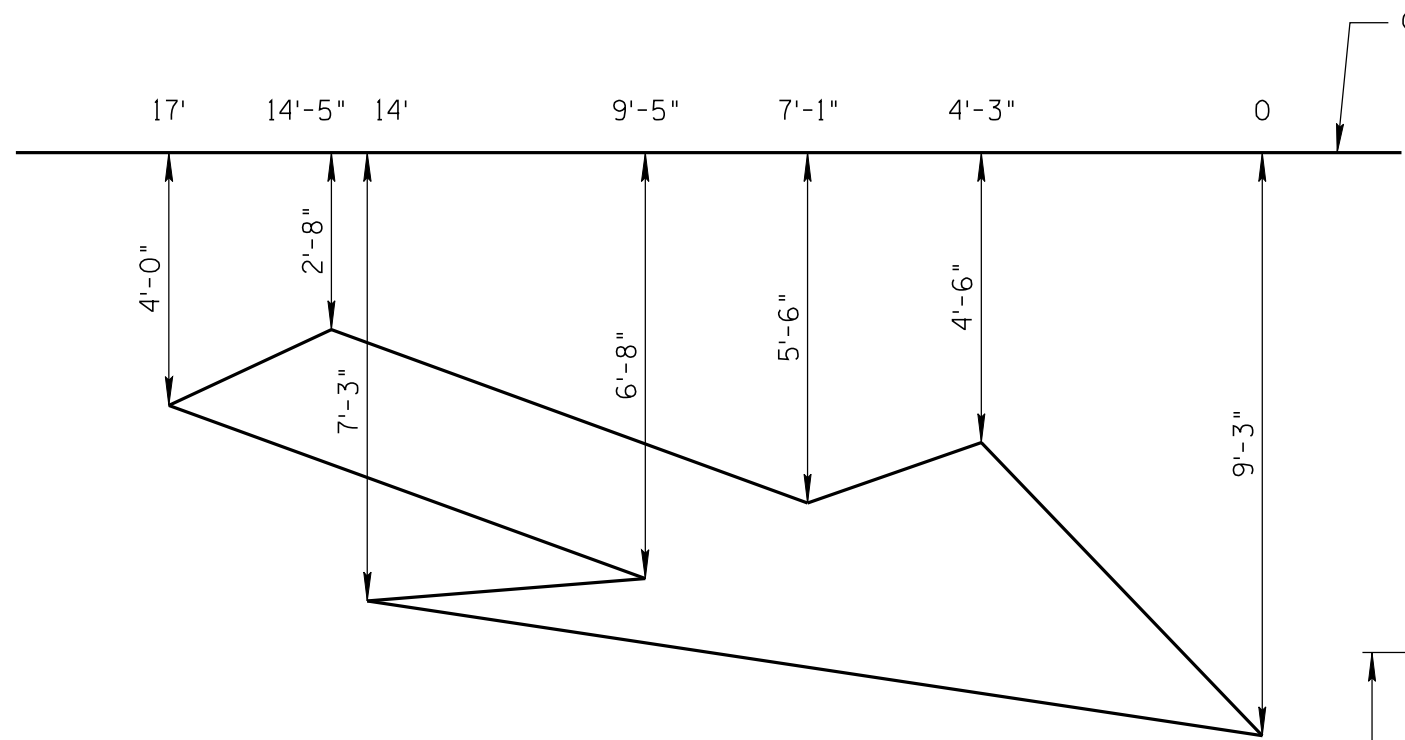

MERGING LEFT TO RIGHT

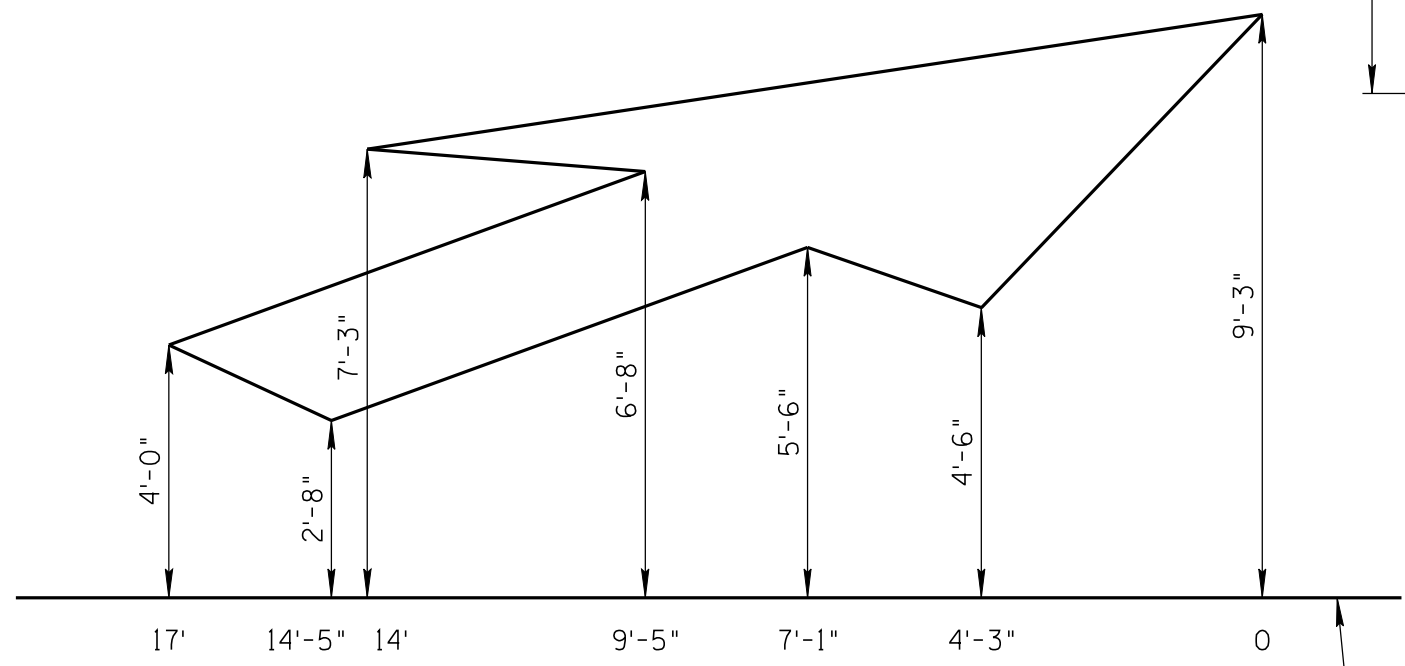

MERGING RIGHT TO LEFT

⊘ Yellow Edge Line

⊘ White Edge Line

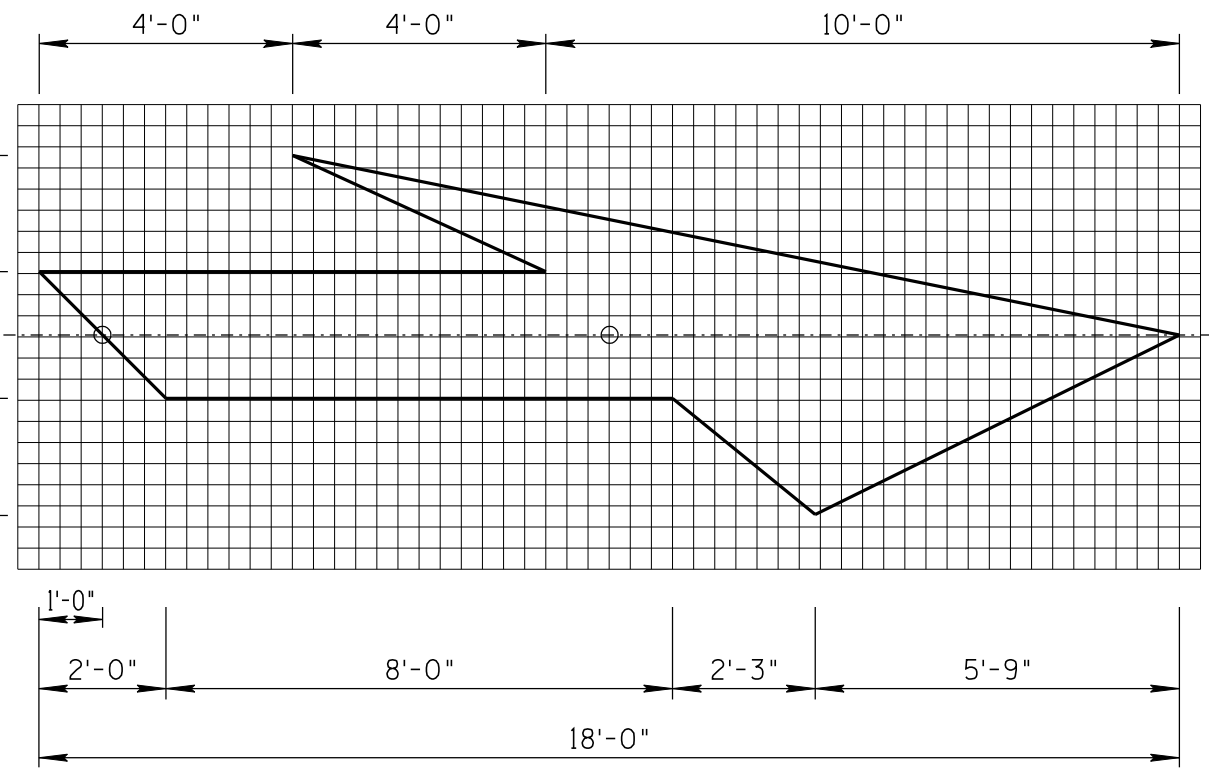

ARROW DETAILS
1 Unit = 4"
White Marking

NOT TO SCALE

DESIGN APPROVED	ARIZONA DEPARTMENT OF TRANSPORTATION INTERMODAL TRANSPORTATION DIVISION TRAFFIC SIGNING & MARKING STANDARD DRAWINGS	REVISION	6/14
SIGNATURES		DRAWING NO.	M-10
APPROVED FOR DISTRIBUTION	PAVEMENT MARKING SYMBOLS	SHEET NO.	2 of 2
ON FILE			

NO	DESCRIPTION OF REVISIONS	MADE BY	DATE
1	RE-ISSUE	L. LOPEZ	2/02
2	MADE THE PAVEMENT ARROW OPTIONAL; CHANGED BORDER	L. LOPEZ	10/10
3	CHANGE TEXT CASE, REVISED CALLOUTS, ADDED NOTES.	L. LOPEZ	6/14
4			

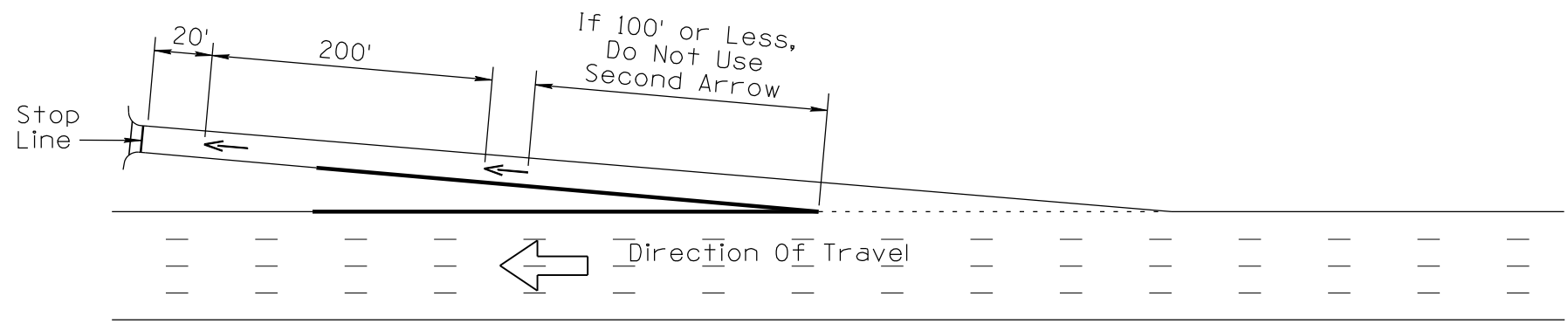

One Lane Terminal

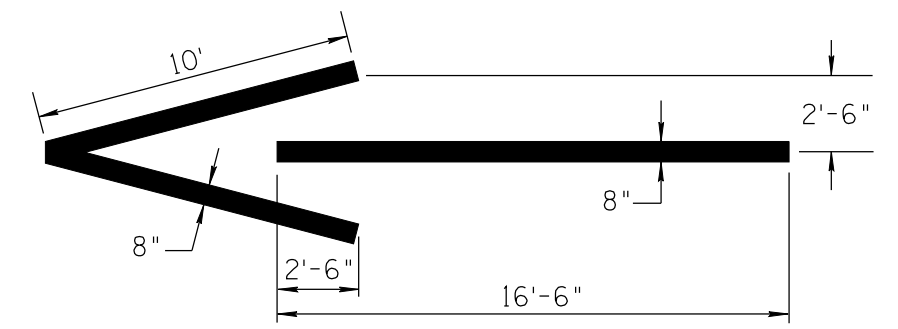

WRONG-WAY ARROW (OPTIONAL)
All Arrows Shall Be White

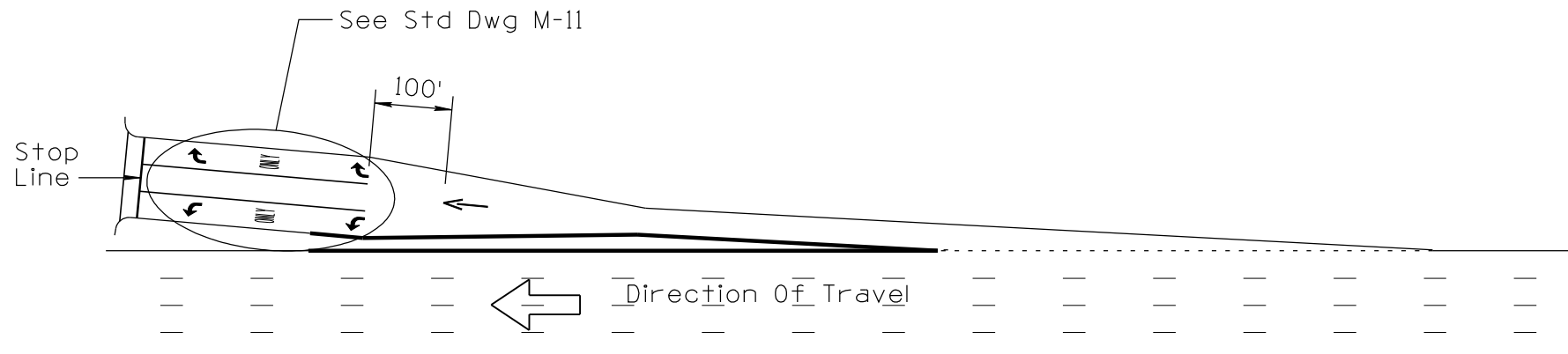

Three Lane Terminal With One Exit Lane

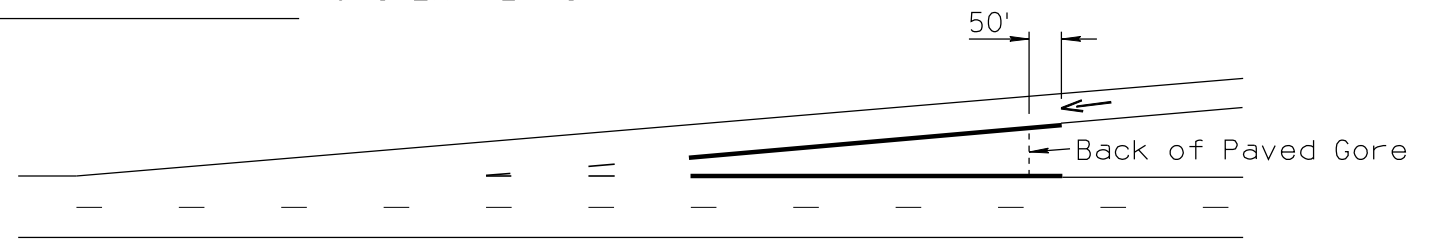

OPTIONAL ON-RAMP APPLICATION

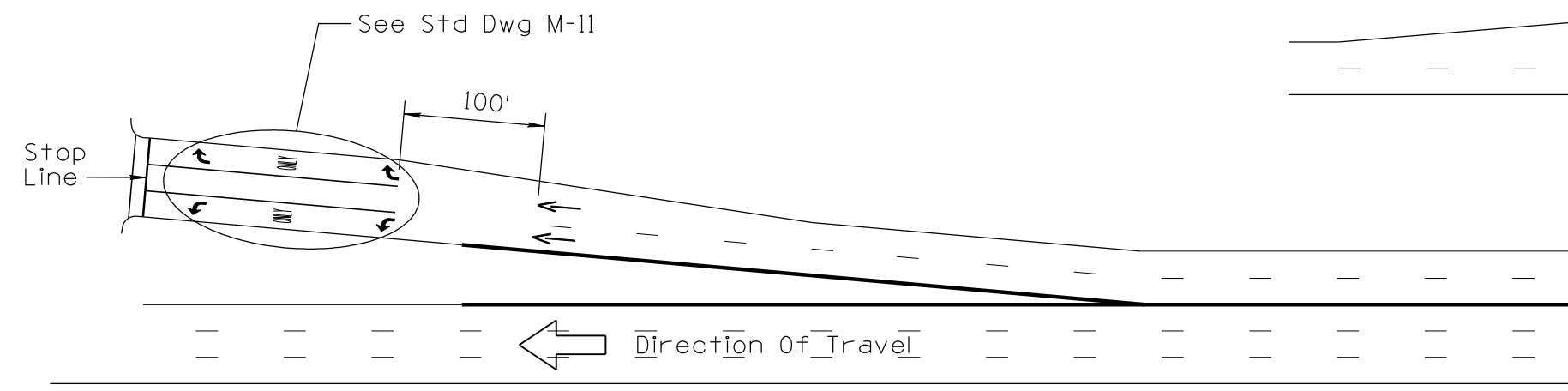

Three Lane Terminal With Two Exit Lanes

NOTES:

- Wrong-way arrows may also be placed in mainline travel lanes on freeways or divided highways based on engineering judgement, but should not be used in lieu of lane use arrows.

NOT TO SCALE

DESIGN APPROVED	ARIZONA DEPARTMENT OF TRANSPORTATION INTERMODAL TRANSPORTATION DIVISION TRAFFIC SIGNING & MARKING STANDARD DRAWINGS	REVISION
SIGNATURES		6/14
APPROVED FOR DISTRIBUTION	WRONG-WAY ARROWS	DRAWING NO.
ON FILE		M-12
		SHEET NO.
		1 OF 1

Note to Designer: The information presented in this Standard Drawing has been prepared in accordance with recognized engineering principles and is for general use. It should not be used for specific application without competent professional examination and verification of its suitability and applicability by a licensed professional engineer. Comments within the inner border line shall not be altered.

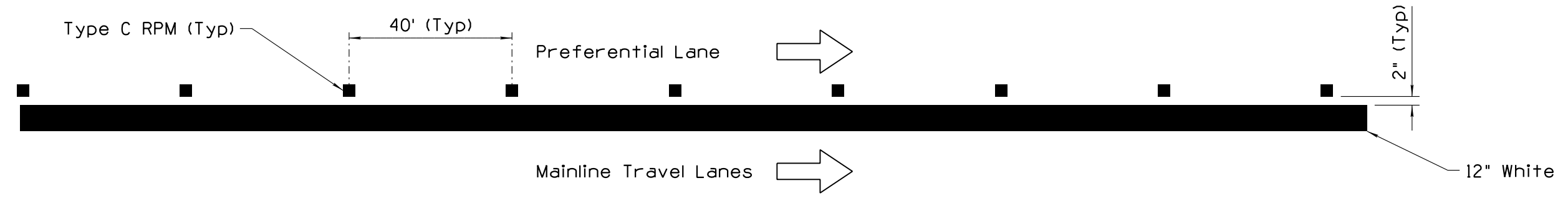

PREFERENTIAL LANE WITHOUT BUFFER

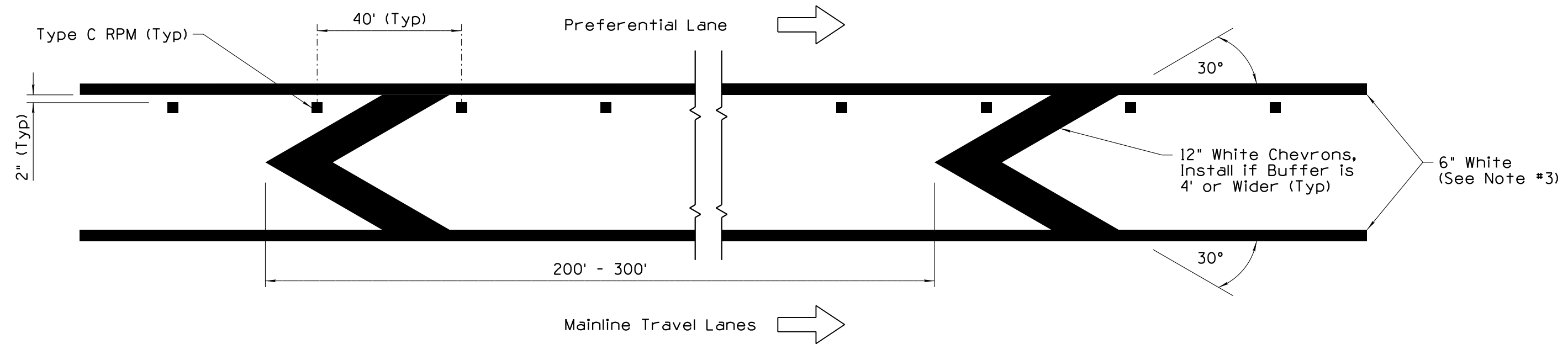

PREFERENTIAL LANE WITH BUFFER

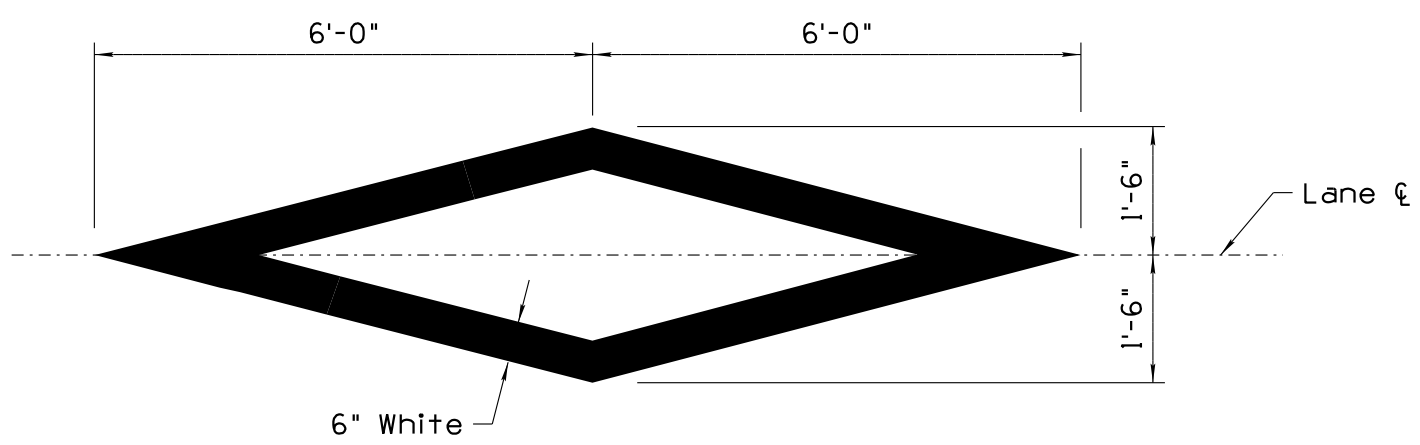

PREFERENTIAL LANE DIAMOND

NOTES:

1. Preferential lane diamonds should be located approximately 1,000 feet apart.
2. All markings shown are solid white.
3. In restricted-width areas, the buffer can be replaced by a single 12 inch solid white line.
4. RPMs should only be placed where preferential lane width is 12 feet or more.

STANDARDS ENGINEER W. FABER	ARIZONA DEPARTMENT OF TRANSPORTATION INFRASTRUCTURE DELIVERY AND OPERATIONS DIVISION TRAFFIC SIGNING & MARKING STANDARD DRAWING	
RECOMMENDED FOR APPROVAL GROUP MANAGER M. HANNA	PREFERENTIAL LANE PAVEMENT MARKINGS AND MARKERS	DRAWING NO. M-13 1 of 1
APPROVED STANDARDS COMMITTEE APPROVED FOR DISTRIBUTION	1/19 DATE	

PRIOR DISTRIBUTION DATE 06/14

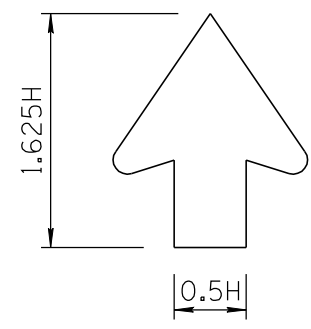

D1 ARROW
One Line Horizontal, Diagonal, or Vertical Arrow

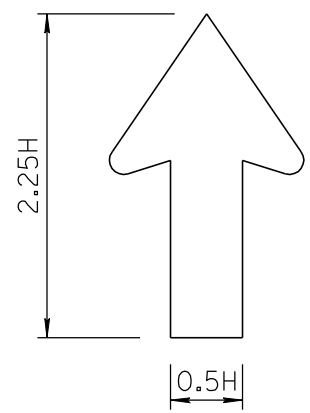

D2 ARROW
Two-Line Vertical or Diagonal Arrow

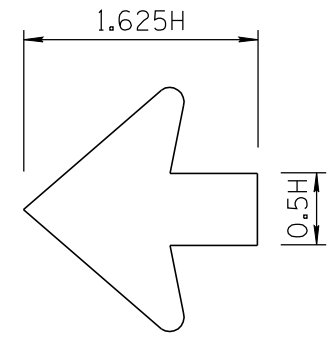

D3 ARROW
Two-Line Horizontal Arrow
Note: "B" dimension is 130% of normal

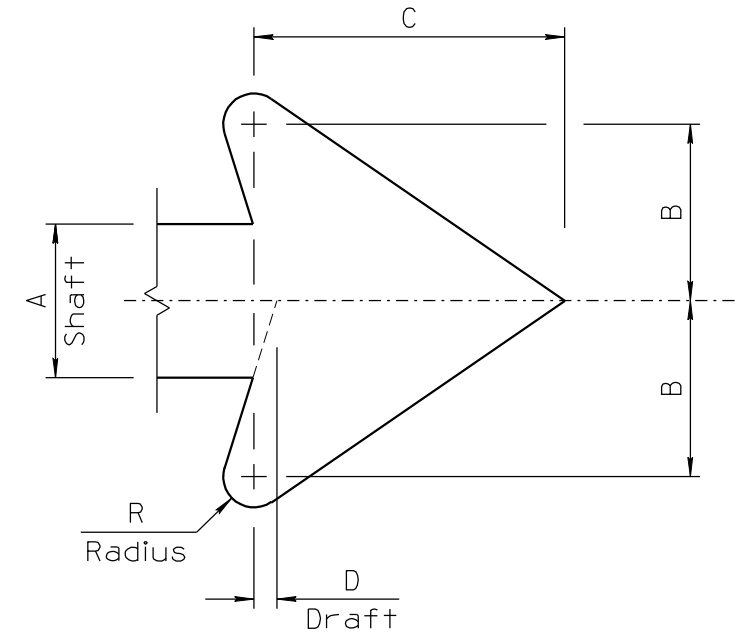

Standard Arrow Details

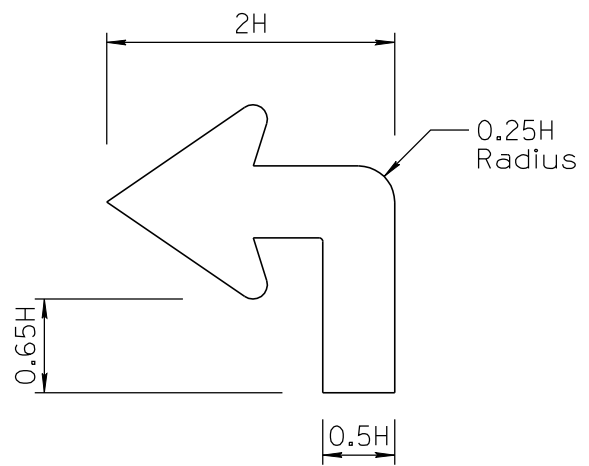

C1 ARROW
Advance Turn Arrow

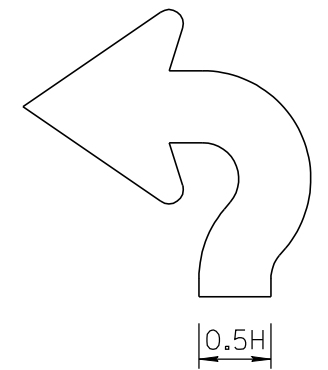

C2 ARROW
Advance Turn Arrow (Roundabout)

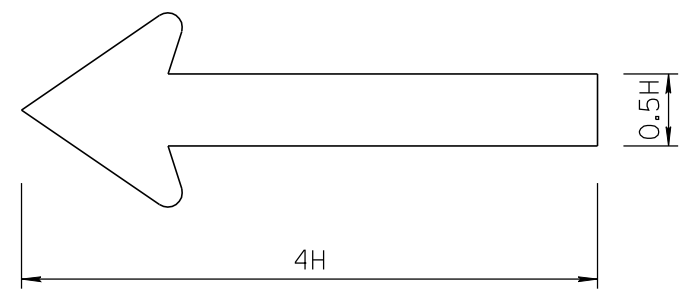

D4 ARROW
Long Horizontal Arrow for Placement at Bottom of Sign Panel

ARROW DIMENSIONS					
H	A	B	C	D	R
2	1	1 ⁵ / ₃₂	2 ¹ / ₃₂	5 ⁵ / ₃₂	3 ³ / ₁₆
4	2	2 ⁵ / ₁₆	4 ¹ / ₁₆	5 ⁵ / ₁₆	3 ³ / ₈
6	3	3 ¹ / ₂	6 ¹ / ₈	7 ¹ / ₁₆	9 ⁹ / ₁₆
8	4	4 ⁵ / ₈	8 ¹ / ₈	5 ⁵ / ₈	1 ³ / ₁₆
10	5	5 ³ / ₄	10 ¹ / ₈	3 ³ / ₄	1
12	6	6 ⁷ / ₈	12 ³ / ₁₆	1 ⁵ / ₁₆	1 ³ / ₁₆
16	8	9 ³ / ₁₆	16 ¹ / ₄	1 ¹ / ₄	1 ⁵ / ₈
20	10	11 ¹ / ₂	20 ¹ / ₄	1 ¹ / ₂	2

NOTES:

- All dimensions are in inches.
- All arrowheads are standard Federal arrowheads except as noted.
- H = Tallest upper case letter height on sign legend.
- Type D arrows are typically used on guide signs for conventional roads. For guide signs on expressways and freeways, use Type A and B arrows on sheet 1.

NOT TO SCALE

DESIGN APPROVED	ARIZONA DEPARTMENT OF TRANSPORTATION INTERMODAL TRANSPORTATION DIVISION TRAFFIC SIGNING & MARKING STANDARD DRAWINGS	REVISION 6/14
SIGNATURES		DRAWING NO. S-12
APPROVED FOR DISTRIBUTION	TYPE C AND D ARROWS	SHEET NO. 2 of 3
ON FILE		

NO	DESCRIPTION OF REVISIONS	MADE BY	DATE	NO
1	NEW ISSUE	D.S. & L.L.	6/14	3
2				4

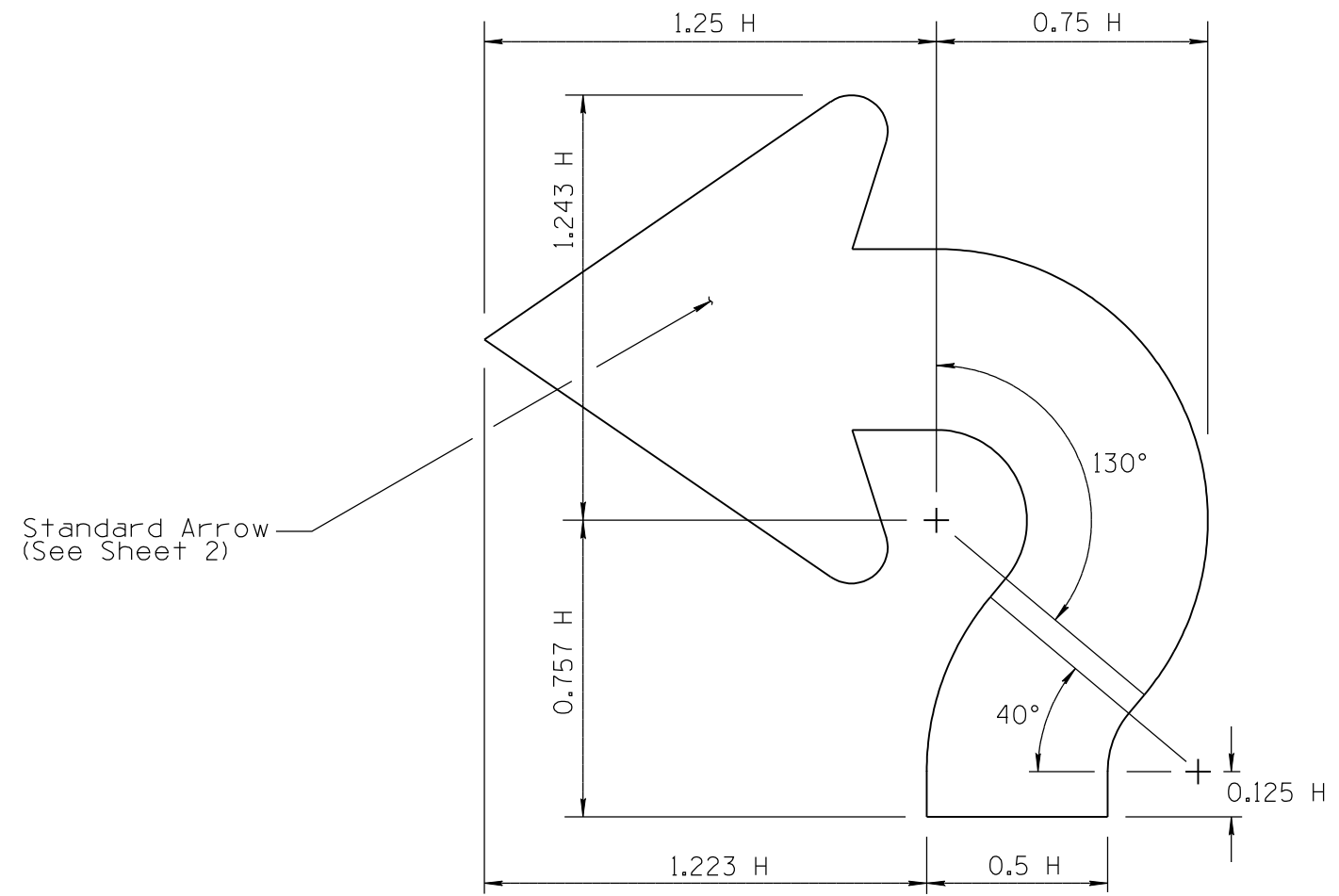

TYPE C2 ARROW

NOT TO SCALE

DESIGN APPROVED	ARIZONA DEPARTMENT OF TRANSPORTATION INTERMODAL TRANSPORTATION DIVISION TRAFFIC SIGNING & MARKING STANDARD DRAWINGS	REVISION	6/14
SIGNATURES		DRAWING NO.	S-12
APPROVED FOR DISTRIBUTION	C2 ARROW DETAIL	SHEET NO.	3 of 3
ON FILE			