

DATE		REVISION		CITY OF CHICAGO		
-		-		TRAFFIC CONTROL DEVICES		
DATE		SHEET				
01/12/07		A-6-10B		CDOT		

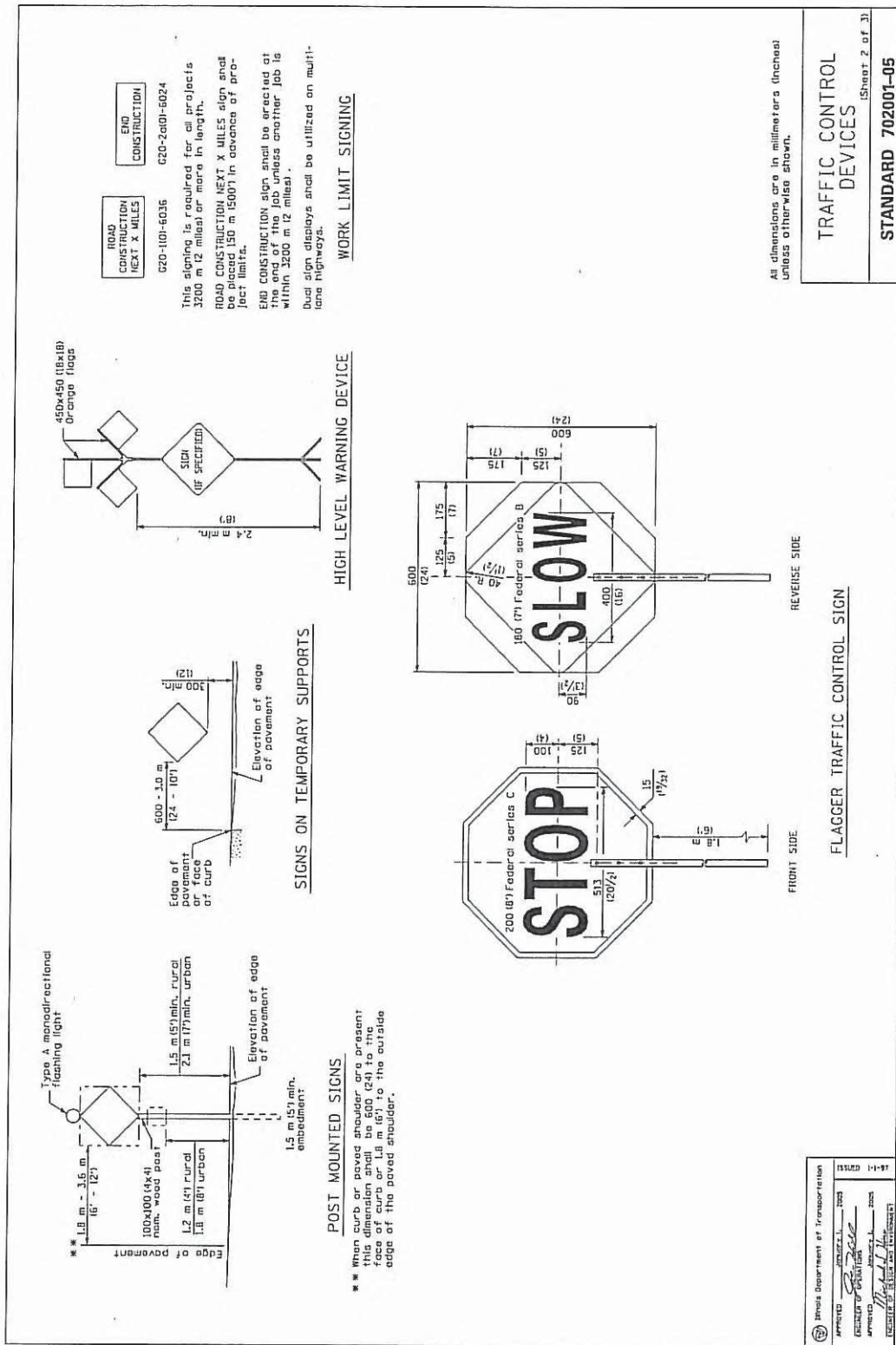

Illinois Department of Transportation
 APPROVED: [Signature] 1/12/07
 CHIEF ENGINEER
 APPROVED: [Signature] 1/12/07
 PROJECT ENGINEER
 ILLINOIS DEPARTMENT OF TRANSPORTATION

AREA = 8.36 ft²

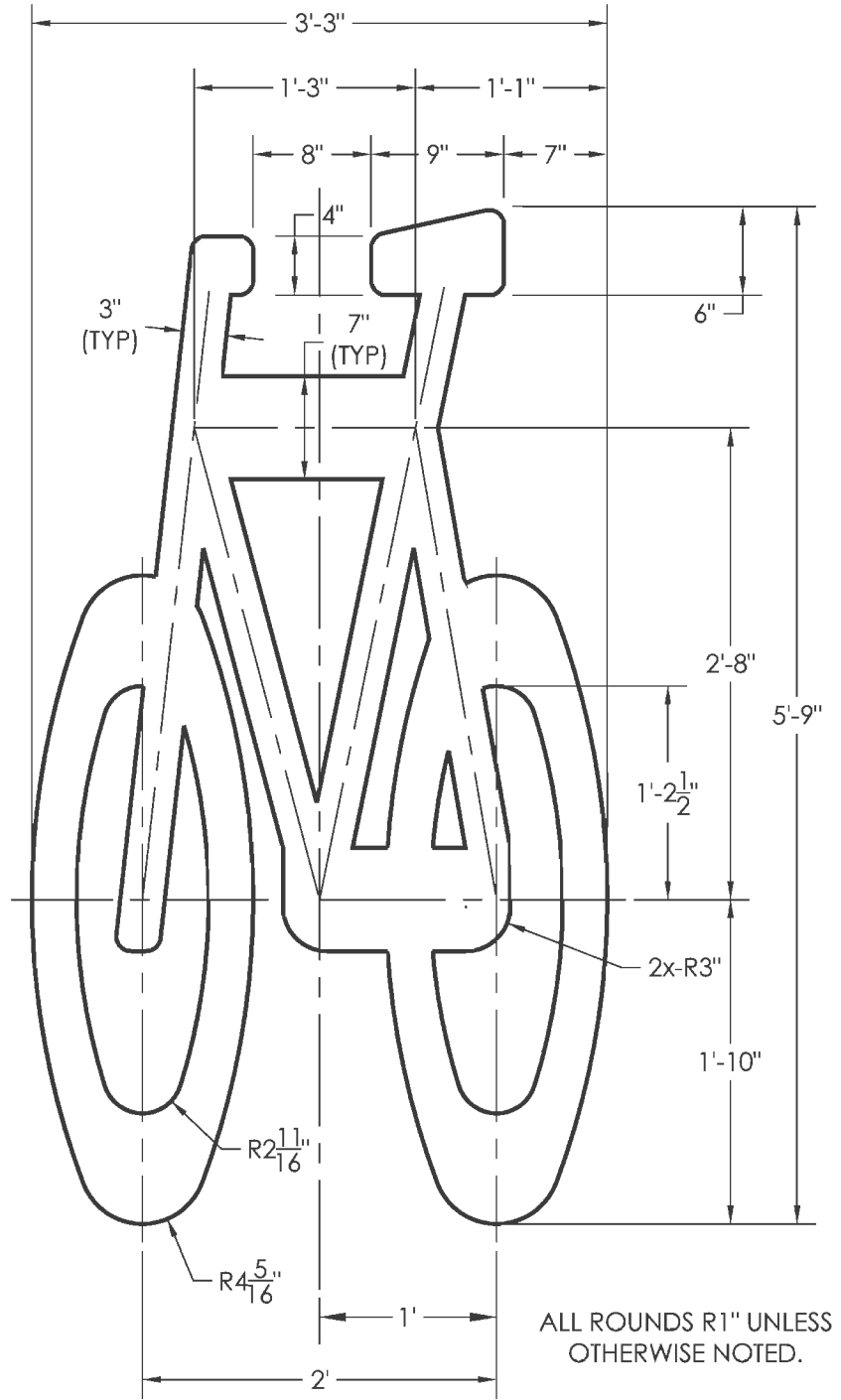

DATE	REVISION	CITY OF CHICAGO		
		6' BIKE SYMBOL		
		DATE	SHEET A-7-2	DRAWN BY
		06/25/12		CDOT

AREA = 16.2 ft²

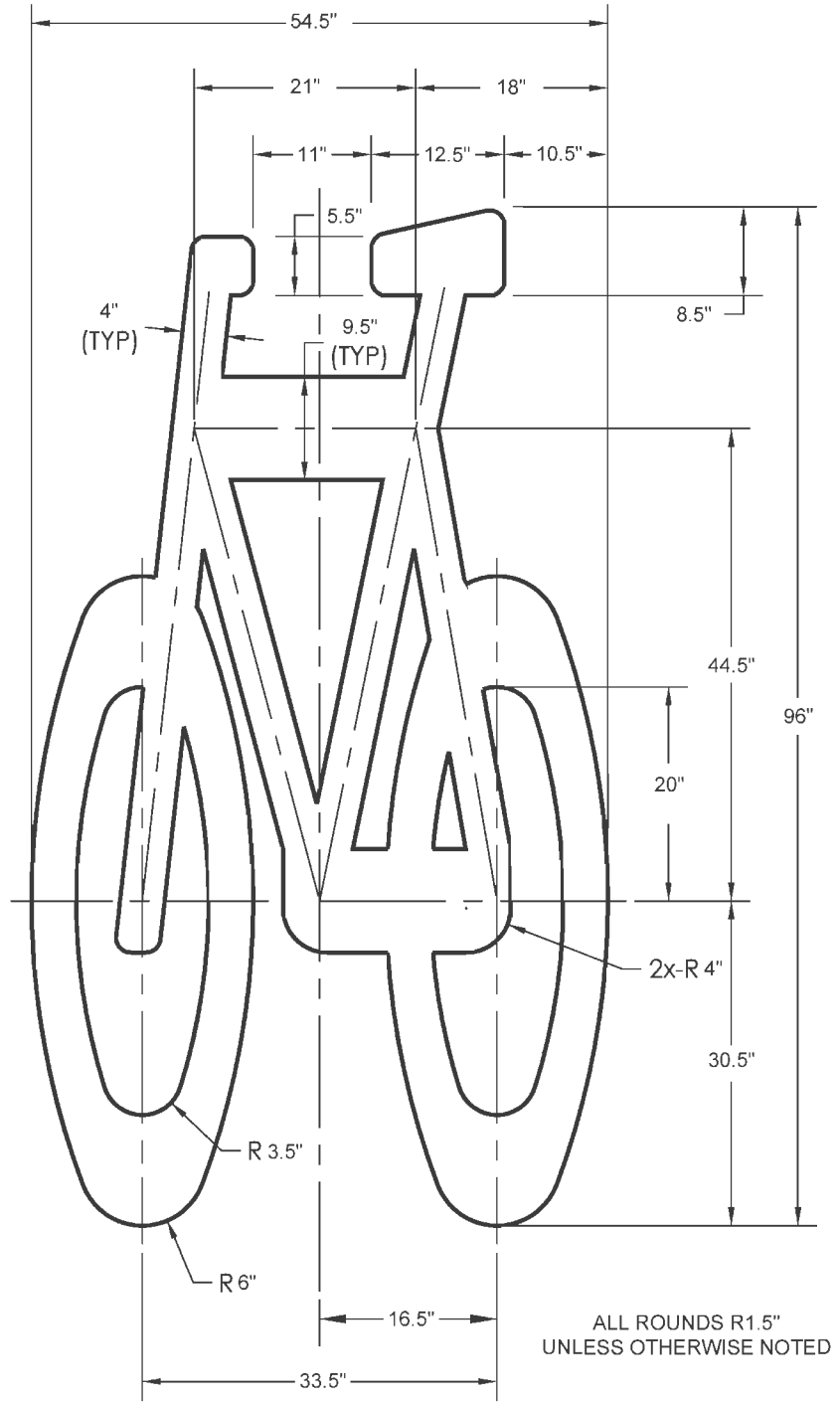

DATE	REVISION	CITY OF CHICAGO		
		8' BIKE SYMBOL		
		DATE	SHEET A-7-3	DRAWN BY
		06/25/12		CDOT

AREA = 4.56 ft²

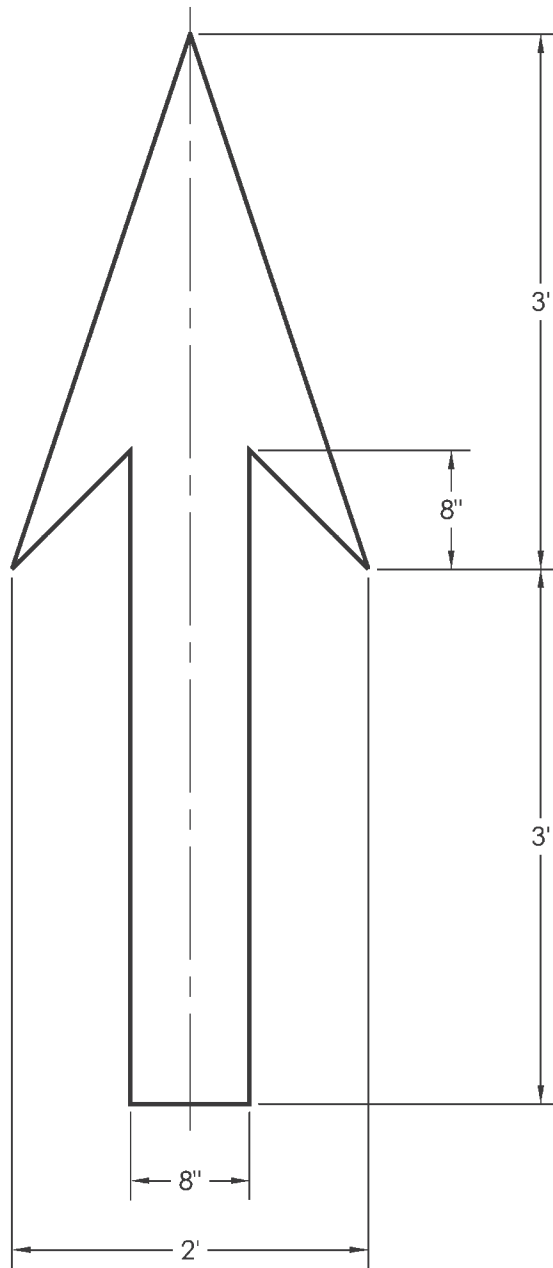

DATE	REVISION	CITY OF CHICAGO		
		BIKE ARROW		
		DATE	SHEET A-7-4	DRAWN BY
		06/25/12		CDOT

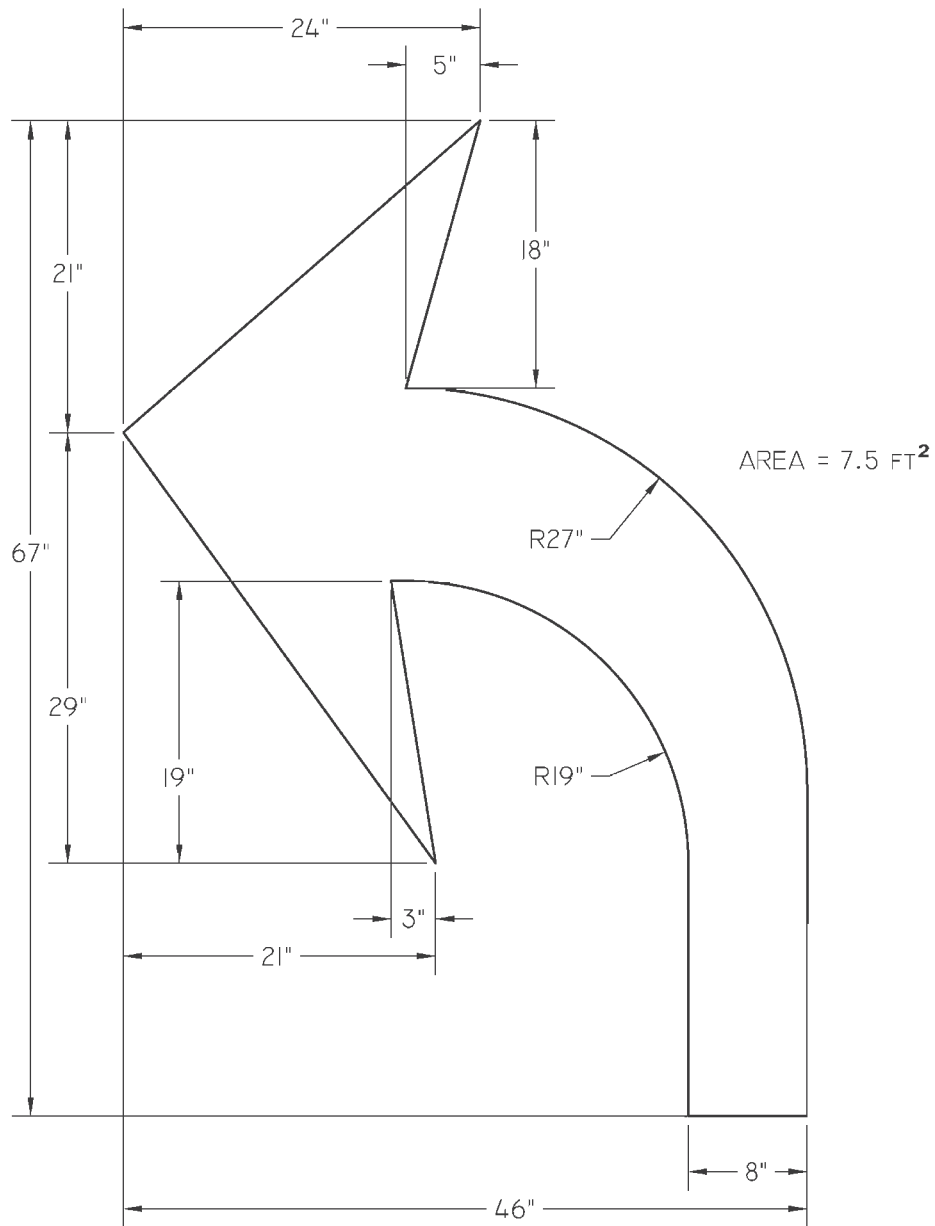

NOTE:
 THIS SPECIFICATION REPRESENTS THE BIKE LEFT
 TURN ARROW. FOR A BIKE RIGHT TURN ARROW,
 USE A MIRROR IMAGE.



DATE	REVISION	CITY OF CHICAGO		
		BIKE TURN ARROW		
		DATE	SHEET A-7-5	DRAWN BY
		06/25/12		CDOT

AREA = 6.68 ft²

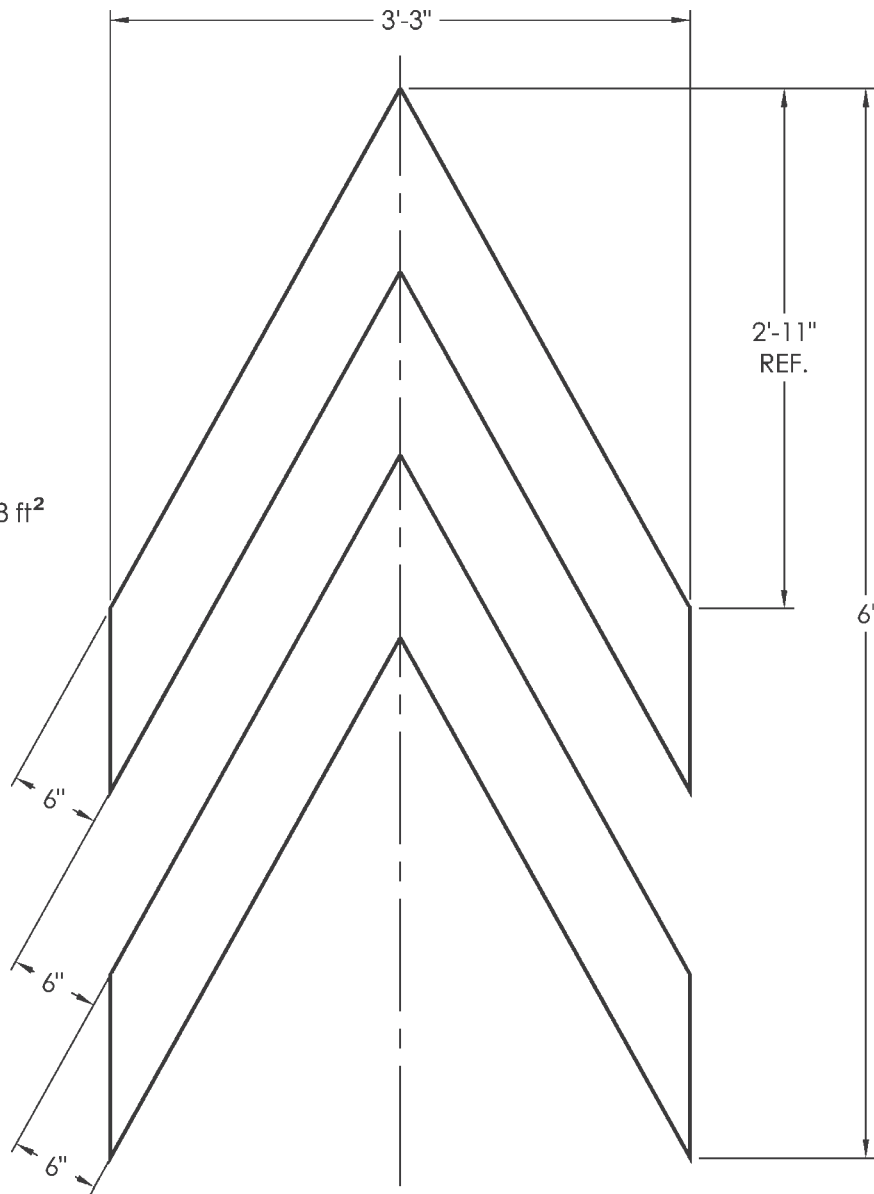

DATE	REVISION	CITY OF CHICAGO		
		BIKE CHEVRON		
		DATE	SHEET A-7-6	DRAWN BY
		06/25/12		CDOT

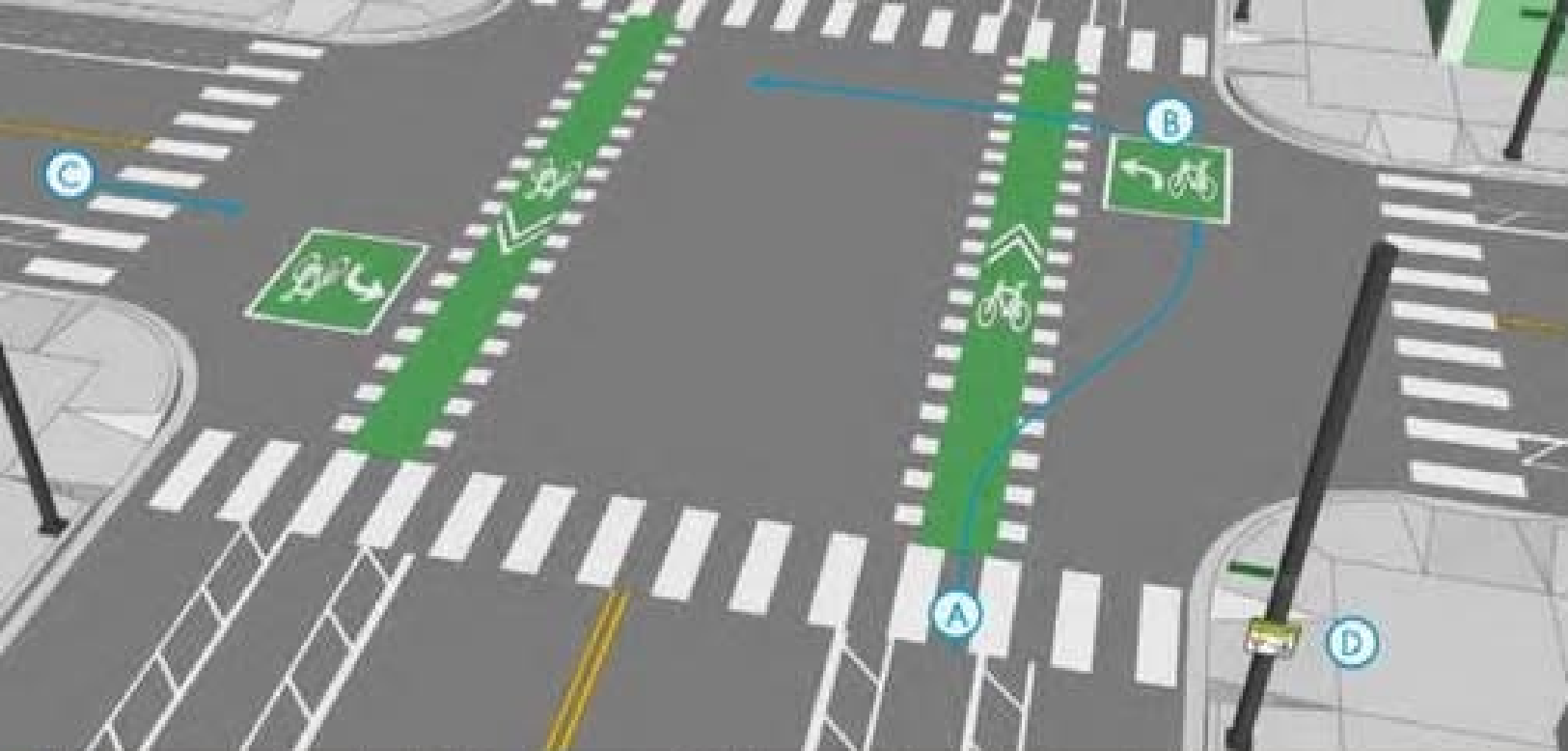

description: A two-stage turn box allows bicyclists who are not comfortable merging into the travel lane to position for a turn at an intersection. They provide a visible storage space away from motorists and other bicyclists allowing easier left turns from a right side bike lane, or right turns from a left side bike lane.

